

MODEL VS SERIES

The Model VS Series snap action thermal protectors feature a shunted design so the bimetallic element does not carry the circuit current, enabling them to carry larger currents than the conductive Model V protectors. The ultra-small, low-profile cases meet tighter space requirements of smaller battery packs and small DC motors. Three different models feature different lead configurations to meet the needs of many applications.

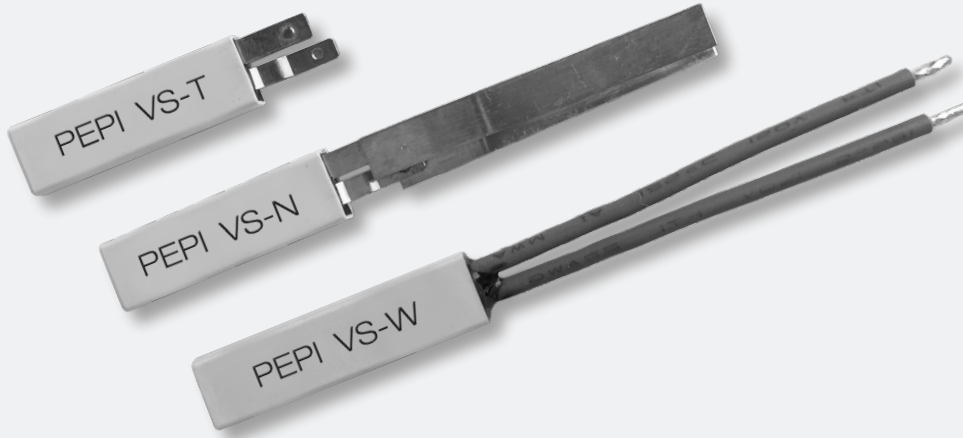

MODEL VS SERIES

TOP VIEW: VS-T

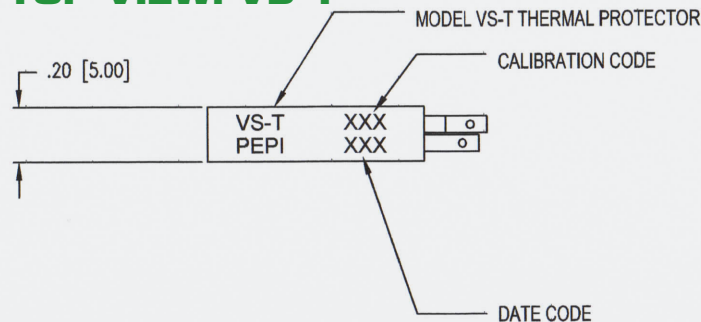

SIDE VIEW: VS-T

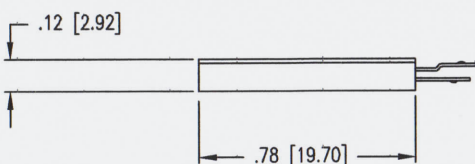

END VIEW: VS-T

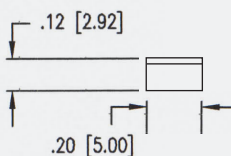

See Other Side for Drawings of VS-N and VS-W

APPLICATIONS

Battery Packs, Small DC Motors, Electronic Circuit Protection

FEATURES

- Snap-action design, quick break/quick make switching action.
- Ultra compact design with a high switching contact rating.
- Shunted design: Bimetallic element does not carry current. Device makes or breaks circuit primarily based on temperature. This results in reducing the internal heating effect of the device when used in applications with higher current loads.
- Automatically resets as ambient temperature falls below the calibration set point.
- Plastic case is electrically isolated from the circuit.
- Preset calibration temperature; not adjustable in the field.

CONTACT RATINGS

- 8 AMPS/18 VDC
- 3 AMPS/24 VDC
- Maximum Breaking Current: 100 AMPS/12 VDC

These ratings are applicable for 6,000 and 10,000 cycles

- UL File No. 873 E37151
- TUV R50042966
- EN 60730-2-9: 2002
- EN 60730-1

CALIBRATION TEMPERATURE RANGE

- Available from 40°C to 100°C in 5°C increments with a standard Tolerance of $\pm 5^\circ\text{C}$ to $\pm 10^\circ\text{C}$
- Reset temperature approximately 30 to 35% lower than the opening temperature

STANDARD CONFIGURATION

- Model VS-N is available with customer specified length of Nickel strips leads and heat shrink insulation over welded lead connections
- Model VS-W is available with UL 3265 XLPE insulated lead wire
- Model VS-T is available with without lead wires

Other configurations available, please contact us for further information

PEPI MODEL VS SERIES

TOP VIEW: VS-N

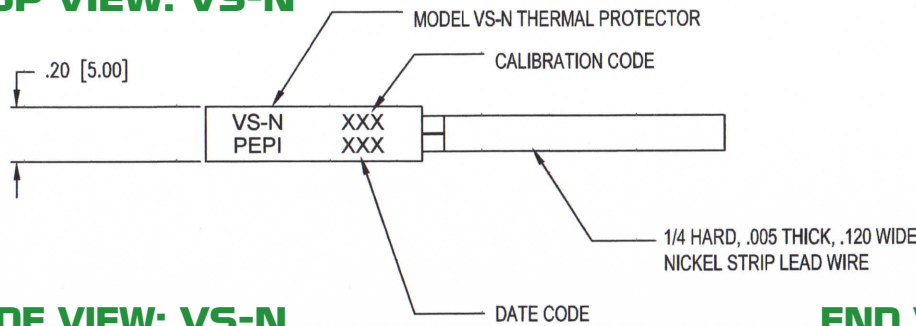

SIDE VIEW: VS-N

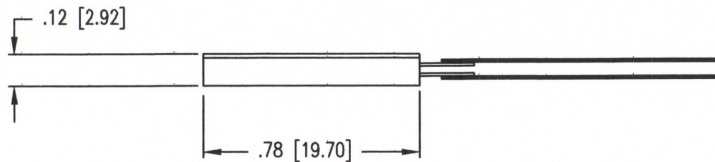

END VIEW: VS-N

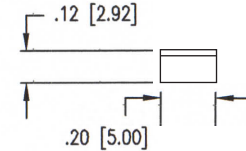

TOP VIEW: VS-W

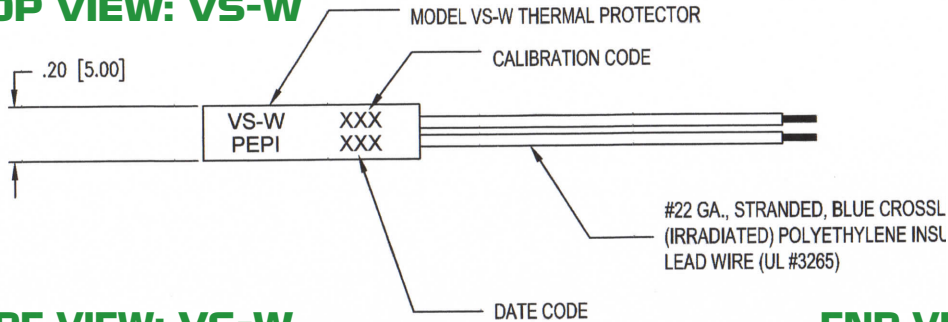

SIDE VIEW: VS-W

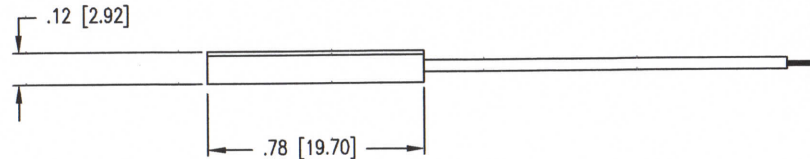

END VIEW: VS-W

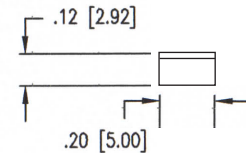

Portage Electric Products, Inc. The Thermal Control Specialists

This sheet contains basic technical and operating characteristic data for our Model VS Series thermal controls. We have presented this data in such fashion, to attempt to provide necessary information for all the various markets which we serve.

Should you have any questions regarding the use of our Model VS devices in your application, please feel free to contact us for additional technical information or assistance.

Since 1963, Portage Electric Products, Inc. has been a world-wide supplier of bimetallic thermostats and thermal protectors. Today, we produce a wide variety of creep-action and snap-action devices for use in motors, transformers and converters, rechargeable battery packs, small and personal care appliances and many other OEM applications.

METRIC DIMENSIONS ARE IN MM (SHOWN IN GREEN)

Copyright 2016, Portage Electric Products, Incorporated, all right reserved

We come through when the heat is on®



Pepi®

Portage Electric Products, Inc.

7700 Freedom Ave. NW, P.O. Box 2170, North Canton, Ohio 44720, U.S.A.

Phone: (330) 499-2727 • 1-888-GO4-PEPI • FAX (330) 499-1853 • e-mail: salesinfo@pepiusa.com • www.pepiusa.com